

# VFS101 Installation Instructions

VFS101-INSISTR, Revision J



# Revision History

<b>Date</b>	<b>Version</b>	<b>Page</b>	<b>Description</b>
12/10/2008	A	-	Initial Release
3/11/2009	B	-	Added Fabrication drawings, additional parts lists
3/25/2009	C	-	Updated Drawings and Cover Page
3/30/2009	D	-	Updated Drawings for additional detail
5/5/2009	E	-	Updated based on DER comments
5/19/2009	F	-	Revised to change parts in Appendixes
5/27/2009	G	-	Revised based on FAA and DER comments
9/7/2010	H	-	Changed Address and Phone number, update document references
11/10/2010	I	-	Changed "Flight Manual Supplement" to "Pilot's Guide"
9/6/2011	J	2	Removed reference to GMA 340 Audio Panel
		6	Removed references to Cessna 182
		8	Added statement that Appendix B shows an example audio panel and removed reference to GMA 340 Audio Panel
		16	Removed reference to GMA 340 Audio Panel

# Table of Contents

1.0 Introduction.....	1
1.1 Referenced Documents.....	1
1.1.1 External Documents.....	1
1.1.2 Internal Documents.....	1
2.0 System Description.....	2
3.0 System Specifications.....	3
4.0 System Components.....	4
4.1 Included.....	4
4.2 Optional Installation Accessories.....	4
4.3 Additional Equipment.....	4
5.0 Limited Warranty.....	5
6.0 Installation Procedures.....	6
6.1 Inspection.....	6
6.2 Mechanical Installation.....	6
6.3 Electrical Wiring Installation.....	8
6.4 Garmin GPS configuration.....	8
6.5 Installation Verification.....	9
6.6 Setting VFS101 Audio Volume.....	11
6.7 Update and Verify VFS101 navigation data.....	12
7.0 Maintenance and Continued Airworthiness.....	14
Appendix A: VFS101 Connector Pin-out.....	15
Appendix B: Wiring Diagram.....	16
Appendix C: Part Numbers.....	18
Appendix D: Mechanical Dimensions.....	19
VFS101 Footprint.....	19
USB Jack Cutout.....	19
Appendix E: Installation Options.....	20
Tray Mount.....	20
Sled Mount.....	21
Panel Mount.....	22
VAS Installation.....	23
Appendix F: Tray / Sled Fabrication Drawings.....	24
Tray Fabrication Drawing.....	24
Sled Fabrication Drawing.....	25
Sled Base Fabrication Drawing.....	26
Appendix G: Compatible GPS Units.....	27

[ This Page Intentionally Blank ]

## **1.0 Introduction**

This document describes the installation procedure for the VFS101 speech recognition system.

### **1.1 Referenced Documents**

#### **1.1.1 External Documents**

- FAA Advisory Circular 43.13-1B, *Acceptable Methods, Techniques, and Practices - Aircraft Inspection and Repair*, Date: September 27, 2001
- FAA Advisory Circular 43.13-2B, *Acceptable Methods, Techniques, and Practices - Aircraft Alterations*, Date: March 3, 2008
- RTCA/DO-254, *Design Assurance Guidance for Airborne Electronic Hardware*
- RTCA/DO-178B, *Software considerations in airborne systems and equipment certification*, Date: December 1, 1992

#### **1.1.2 Internal Documents**

- VFS101-PMAN, *VFS101 Pilot's Guide*
- VFS101-ICA, *VFS101 Instructions for Continued Airworthiness*
- VFS101-INSDWG, *VFS101 Installation Drawing*

## 2.0 System Description

The VFS101 is a speech-recognition system which allows aircraft pilots to enter aircraft navigational data using their voice. Voice entry of navigational data can be performed approximately ten times faster than by manual knob twisting. The VFS101 system operates with the Garmin GNS 430 and GNS 530 series of GPS navigational units, and supports installations with one and two GPS units present. See Appendix G for a complete list of compatible GPS units.

The VFS101 system consists of a single 3.3 in x 5.5 in x 1 in, unit which is mounted behind the aircraft's instrument panel. This unit has a single DB-25 connector and utilizes an installer-fabricated wiring harness with connections to:

- One or two Garmin GNS 430 or 530 GPS units
- An audio panel with an available un-switched input having a nominal input impedance of no less than 500 Ohms.
- A Universal Serial Bus (USB) jack used for navigational data and software updates
- A pushbutton switch (yoke-mounted) called the VoiceFlight Activation Switch (VAS)
- 14 or 28 Volt DC aircraft power via a separate 1 Amp resettable circuit breaker (A dedicated power switch and 1 Amp fuse is an acceptable alternative)

The VFS101 is suitable for operation only on aircraft with a negative ground battery.

### 3.0 System Specifications

<b>Specification</b>	<b>Value</b>
Weight	0.75 lbs
Overall Dimensions	Length: 5.44 in. (138.2 mm) Width: 3.24 in. (82.2 mm) Height: 0.95 in. (24.13 mm)
Power Requirements	14 – 28V DC, less than 1 Ampere
Temperature (operating)	-20° C - +55° C (-68° F - +131° F)
Temperature (storage)	-55° C - +85° C (-131° F - +185° F)
Maximum Altitude	25,000 ft (8202 m)
Audio Input	Impedance: 18K Ohms minimum
Audio Output	Power: 40 mW minimum into a 600 Ohm load
Regulatory Compliance	DO-160E categories tested: Temperature and Altitude: B1 Temperature Variation: C Humidity: A Operational Shock: B Vibration: S Magnetic Effect: Z Emission of RF energy: M DO-160E categories demonstrated by analysis: Crash Safety: B Fire and Flammability: C Hardware developed under DO-254: Level D Software developed under DO-178B: Levels C and D

## **4.0 System Components**

### ***4.1 Included***

As shipped, the VFS101 system (VFS101-KIT001) includes the following items:

- VFS101-AS001, VFS101 unit with Installed Software
- VFS101-Z001, USB mass storage drive (“thumb drive”) with VoiceFlight Logo
- VFS101-INSISTR, VFS101 Installation Instructions
- VFS101-PMAN, VFS101 Pilot's Guide
- VFS101-QRC, VFS101 Pilot's Quick Reference Card

### ***4.2 Optional Installation Accessories***

The VFS101 Installation Accessory kit (VFS101-KIT002) includes:

- VFS101-CA004, USB Jack and cable assembly
- VFS101-M007, USB jack mounting plate
- Two screws for affixing the mounting plate

### ***4.3 Additional Equipment***

The following items are supplied by the installer. A list of specific part numbers which have been identified as acceptable for use with the VFS101 system are listed in appendix C.

- Cables will be fabricated by the installer. See appendix B for interconnect diagrams.
- Hardware for mounting the VFS101 unit in the chosen location, including #8 bolts
- Appropriate cable retention hardware (cable clamps, etc.)

## **5.0 Limited Warranty**

VoiceFlight Systems LLC warrants its new products and parts against defects in material and/or workmanship for two years from the date of purchase. During this period, VoiceFlight Systems LLC will, at its sole option, repair or replace defective product or parts without charge to you, excluding shipping.

The warranties and remedies contained herein are exclusive and in lieu of all other warranties express or implied or statutory, including any liability arising under any warranty of merchantability or fitness for a particular purpose, statutory or otherwise. This warranty gives you specific legal rights, which may vary from state to state.

IN NO EVENT SHALL VOICEFLIGHT SYSTEMS LLC BE LIABLE FOR ANY INCIDENTAL, SPECIAL, INDIRECT OR CONSEQUENTIAL DAMAGES, WHETHER RESULTING FROM THE USE, MISUSE, OR INABILITY TO USE THIS PRODUCT OR FROM DEFECTS IN THE PRODUCT. Some states do not allow the exclusion of incidental or consequential damages, so the above limitations may not apply to you.

VoiceFlight Systems LLC retains the exclusive right to repair or replace the unit or software or offer a full refund of the purchase price at its sole discretion. Such remedy shall be your sole and exclusive remedy for any breach of warranty.

To obtain warranty service contact VoiceFlight Systems customer service at:

VoiceFlight Systems, LLC  
105 Jordan Road  
Troy, NY 12180  
Telephone: (518) 720-0060

## 6.0 Installation Procedures

This section describes the procedures for installing the VFS101 speech recognition system, and for verifying the unit has been installed correctly. Refer to the latest revision of the VFS101 STC for applicability information.

Installing the VFS101 requires specialized expertise and equipment, including the correct fabrication and installation of the complex wiring harness. An appropriately rated certified aircraft repair station must be employed to perform the installation. Failure to follow the procedures described here and in the referenced documents may result in voiding the VFS101 warranty and/or a non-airworthy installation.

### 6.1 Inspection

Unpack the unit and verify there has been no visible damage in shipping. Verify that all the items listed in section 4.1 are present. If the unit or accessories have been damaged in shipment save all packing material and contact the freight carrier. Contact VoiceFlight Systems for a replacement unit. Do not install a damaged unit into an aircraft.

### 6.2 Mechanical Installation

1. Select an installation location. Three different installations are approved. A diagram of each is shown in Appendix E:
  - a) Tray mount: This is a simpler installation if space is available in the aircraft's avionics rack.
  - b) Sled Mount: This installation is the preferred method if space is available in the aircraft's avionics rack. It allows for easier access to the device in the event service is required.
  - c) Panel Mount: This installation can be used in the event no space is available in the aircraft's avionics rack.
2. Install the VFS101 unit using the selected method. This installation must be conducted in accordance with the guidance provided in FAA Advisory Circular 43.13-2B, chapter 2.

The VFS101 unit weighs .75 lbs., thus the location it is mounted must be capable of restraining this mass when subjected to the applicable G-forces as specified in FAA Aviation Circular(AC) 43.13-2B, chapter 1. Allow space for the DB-25 connector and back-shell that will be attached. Forced-air cooling of the VFS101 is not specifically required. Avoid mounting the VFS101 in a location where hot air will be blown directly on the unit.

Fabrication instructions for the Tray and Sled mounts can be found in Appendix F.

3. Locate a suitable location for installation of the VFS101 USB jack. This location does not need to be accessed by the pilot in-flight, but should be convenient for monthly database updates. Cut a hole in the panel and drill two screw holes as shown in appendix D. Install the USB jack from behind the panel. If using the optional installation kit, the USB mounting plate fits behind the USB jack, and has two threaded holes to accept the #4-40 screws provided. Label the USB jack "VFS USB" using an appropriate placard.

4. Select a location for the VoiceFlight Activation Switch (VAS) on the aircraft yoke within easy reach of the pilot. Suitable switches are listed in Appendix C. Install the switch and label it "VAS" with an appropriate placard in accordance with FAR 23.1555(a).

The preferred location for the VAS is atop the left stalk of the pilot's yoke. In the event this location is occupied by other switches, position the VAS in a location where it will not be inadvertently triggered, or result in other switches being triggered by mistake.

Mount the switch as is customary for auxiliary switches and the model of yoke installed in the aircraft. This will involve threading wires through the body of the yoke and connecting those wires to the rest of the VFS101 wiring harness. If necessary, install a self-coiling cable to connect the yoke wiring to the aircraft panel. Recommended part numbers are listed in Appendix C. Verify the cable is long enough by moving the yoke through its full range of motion and verifying the cable does not restrict it in any way.

5. Locate an unused circuit breaker location on the aircraft's circuit breaker panel and install a 1 Amp resettable type circuit breaker which is approved for aircraft use. As this circuit breaker will be used to remove power from the VFS101 in the event of a malfunction, no other equipment may be tied to the VFS101 circuit breaker.

If no circuit breaker locations are available on the circuit breaker panel, install the breaker in a suitable location elsewhere on the instrument panel and within reach of the pilot.

A dedicated, readily accessible power switch, together with a similarly rated fuse may be used in lieu of a circuit breaker. As with the circuit breaker, no other equipment may be tied to the VFS101 fuse and power switch.

Label the circuit breaker or power switch "VFS" with an appropriate placard per FAR 23.1555(a).

## **6.3 Electrical Wiring Installation**

1. Examine the wiring diagram in Appendix B. Assemble the necessary components, and plan the wires routes. The part numbers of appropriate parts are listed in Appendix C.
2. Fabricate the cable harness according to the wiring diagrams shown in Appendix B. **In these diagrams, a GMA 340 audio panel is shown as an example. Select an available un-switched audio input on the installed audio panel with a nominal input impedance of no less than 500 Ohms.**

The VFS101 power and ground connections will be made to the Avionics buss and Avionics ground.

The Aviation-out data port may be used to feed multiple pieces of equipment, however if no isolating RS-232 splitter is used, no other piece of equipment connected to the same bus may cause more than a "minor" hazard should that unit lose Aviation-out data.

Pay special attention to connect the shields as shown in the wiring Diagram (Appendix B), as additional noise on the audio connections induced by incorrect grounding and shielding will degrade system performance. Avoid routing wire bundles near high-current wires to avoid inducing additional noise in the system. The splice connection to the pilot microphone jack should be done as close to the jack as possible. The shields leading to the VFS101 must not contact the shields leading to the audio panel to avoid undesirable ground loops (see the wiring diagram in Appendix B). Proper fabrication techniques must be used for all wires. Refer to FAA Advisory Circular 43.13-2A for further information.

3. Verify the correct wiring of the cable harness by performing continuity and voltage checks with a multi-meter before applying power to the unit. Incorrect wiring could damage the VFS101 or connected equipment. Pay special attention to verifying that aircraft power appears only on pin 13 of the VFS101 connector.
4. Verify that the aircraft's pilot headset jacks are electrically isolated from the aircraft panel and other mounting surfaces. If they are not, an isolation shoulder washer set must be installed at the jack. Appropriate part numbers can be found in Appendix C.
5. Restrain the cable harness as required by FAA Aviation Circular 43.13-1B Chapter 11. Verify that the cable bundles are restrained well away from all controls. Move all aircraft controls through their full range of motion to confirm that no interference exists.

## **6.4 Garmin GPS configuration**

The VFS101 communicates with the GNS 430 or GNS 530 GPS unit(s) by way of the crossfill protocol typically used to transmit flightplans from one GPS to the other in a dual GPS installation. As such, the RS-232 channel(s) to which the VFS101 is to be connected must be configured as a "Crossfill" port on the GPS. Channel 3 is recommended for this purpose, and this port's pin numbers are shown in the wiring diagrams.

The GPS crossfill input and output must reside on the same channel. Configuration information for the RS-232 data ports can be found in the Garmin GNS 430 and GNS 530 installation manuals.

Additionally, one RS-232 output port on the primary GPS must be configured to "Aviation". The wiring diagram in Appendix B shows this connection using RS-232 channel 1, and the use of this channel is recommended. The information provided on this port is used by the VFS101 to determine the current position and speed of the aircraft.

## **6.5 Installation Verification**

This procedure verifies the correct installation of the VFS101.

1. Park the aircraft in an outside, open area where it can receive GPS satellite signals. Power on the VFS101, the aircraft audio panel, and the connected Garmin GNS 430 or GNS 530 GPS unit or units.
2. Verify the primary GPS is receiving GPS signals from at least five satellites. This information can be found on the satellite status page of the Primary GPS.
3. Plug a suitable aviation headset (with microphone) into the pilot station audio jacks. Position the microphone so that it is close to the lips.
4. After waiting at least one minute for the VFS101 to initialize, adjust the primary GPS to display flightplan #19. This is done by pressing the FPL control button and rotating the small right hand knob to display the stored flightplan catalog. Then, press the small right hand knob to activate the cursor and rotate the large right knob to scroll down to Flightplan #19. Confirm that the title line shown for this flightplan is "-- VOICE FLIGHT --". Press the ENT key to display the flightplan.

If there is no flightplan titled "-- VOICE FLIGHT --", this indicates that either the VFS101 is not receiving power, that there is a problem with crossfill communications between the VFS101 and the primary GPS, or a failed VFS101 unit. The most likely problems with crossfill communications are a misconfigured GPS or a wiring problem. Proceeding to the following step may help to eliminate some of these possibilities.

5. Depress and hold the VoiceFlight Activation Switch (VAS). The VFS101 should play one of the following messages:
  - A rapid “double beep”: This indicates the unit is powered, the VAS is working, the system is receiving Aviation Data from the primary GPS, and the unit's navigational database matches the one installed on the primary GPS.
  - An audio message “WARNING: Navigational data is not current”: This is normal at this stage. Section 6.7 of this document describes how to update the navigational database. Note, you must hold down the VAS until the warning message completes, or it will repeat each time you depress the VAS.
  - An error tone not followed by an error message. This indicates the VFS101 unit is powered, the VAS is working, but the system is not receiving aviation data from the primary GPS. Verify the GPS is receiving a GPS signal from at least 5 satellites. Other likely causes of this problem are a misconfigured GPS and a problem with the Aviation-Out wiring.
  - No sound: This indicates possible audio output problems, a problem with the VAS, or a VFS101 failure. Likely causes of audio output problems include incorrect settings on the audio panel, a wiring problem between the VFS101 and the audio panel or a failed headset or headset jack. Possible VAS problems include a failed switch or a wiring problem.
6. Depress the VAS, speak the words “START NEW FLIGHTPLAN” clearly and distinctly. A confirming single beep should be heard. Any contents of flightplan #19 will be cleared.

If an error tone is heard, address the following issues and try again:

- Microphone: position the headset microphone as close to the lips as possible.
- Excessive Background Noise: The VFS101 is resistant to background noise, but extremely high levels can cause a problem.
- Speech not consistent with VFS101 requirements: Be sure to speak slowly and clearly.

If several attempts generate error tones, this may indicate an audio input problem. This can be caused by excessive electrical noise on the audio lines, improperly shielded wiring, a failed headset microphone or jack, or a failed VFS101.

7. Enter a nearby aviation waypoint (such as an airport identifier) within 200 miles of the current location by spelling it out using the

ICAO spelling alphabet (e.g. KBOS=K ILO BRAVO OSCAR SIERRA), followed by the word, "ENTER". Speak slowly and clearly. If entering an airport identifier remember that many airports in the continental U.S. begin with a K ("KILO").

The ICAO spelling alphabet can be found on the back of the VFS101 Quick Reference card, or in the VFS101 Pilot's Guide. The VFS101 should generate a single beep, and the spoken waypoint should appear as the first waypoint in flightplan #19. If an error tone is heard, try a different waypoint, again followed by the word "ENTER". Release the VAS. Verify that the entered waypoint appears as the first waypoint in flightplan #19 on the primary GPS.

This step has verified that the VFS101 unit is functioning normally.

8. In dual GPS installations initiate a manual crossfill of the VoiceFlight Flightplan (flightplan #19) on the primary GPS by pressing the MENU control button, selecting "Crossfill?" from the menu using the large right knob, then pressing the ENT control button. Confirm that the flightplan was successfully transferred to the secondary GPS by viewing the contents of flightplan #19 on the secondary GPS using the actions listed above in step #4. Verify that the waypoint entered on the primary GPS in step #7 appears here.

This step confirms that the crossfill wiring to the secondary GPS is correct.

9. Examine the primary GPS message display window by pressing the MSG button and confirm that no data transmission errors have been reported. In dual GPS installations, repeat the Crossfill Test for the secondary GPS.
10. The navigation update performed in section 6.7 will verify proper installation of the USB jack.

## **6.6 Setting VFS101 Audio Volume**

If the volume level of the VFS101's audio output requires adjustment relative to other audio sources, the following procedures may be used. These procedures are only to be used while the aircraft is not moving.

To INCREASE the VFS101 audio output volume:

1. Plug a suitable aviation headset into the pilot headset jack.
2. With the aircraft audio panel, VFS101 and primary GPS powered up, enter a new title for stored flightplan #19 on the primary GPS containing the letter "U" (for UP) in the first character position and press ENT to install the new title. Briefly depress and release the VAS.

3. The title line will change to: "V <Volume Level 0-63> UP?" where the content in < > is replaced with a number indicating the current volume level.
4. Briefly press and release the VAS again. This will increase the volume by one step. A tone should be heard through the headset at the new volume level. Repeat until the volume is at the desired level.
5. Depress and hold the VAS for at least two seconds. This will return the VFS101 to normal operations, with the new volume output level.

To DECREASE the VFS101 audio output volume:

1. Plug a suitable aviation headset into the pilot headset jack.
2. With the aircraft audio panel, VFS101 and primary GPS powered up, enter a new title for stored flightplan #19 on the primary GPS containing the letter "D" (for DOWN) in the first character position and press ENT to install the new title. Briefly depress and release the VAS.
3. The title line will change to: "V <Volume Level 0-63> DOWN?" where the content in < > is replaced with a number indicating the current volume level.
4. Briefly press and release the VAS again. This will decrease the volume by one step. A tone should be heard through the headset at the new volume level. Repeat until the volume is at the desired level.
5. Depress and hold the VAS for at least two seconds. This will return the VFS101 to normal operations, with the new volume output level.

## **6.7 Update and Verify VFS101 navigation data**

The VFS101 system uses navigational data to improve speech recognition accuracy and to communicate with the attached Garmin GNS 430 and/or GNS 530 GPS units. The cycle number of the VFS101 navigational database must match the cycle number of the navigational database installed on the primary GPS. If they do not match the VFS101 will play a warning message the first time the VAS is pressed after the VFS101 is powered on, some waypoints may be unavailable for recognition, and Victor airway expansions may be incorrect.

The navigation database should be updated to the current navigational cycle before the aircraft is returned to service. This is performed by the following procedure:

1. Download the latest navigational database from the "Navigation Update" section of the VoiceFlight Systems website (<http://www.voiceflight.com>). If the website is unavailable contact VoiceFlight systems customer support at (518)-720-0060 for an

alternative means of delivery. The computer used for this should be running a recent version of Microsoft Windows, Apple OS X or Linux to insure proper support for the USB flash drive used in step 2.

2. Insert the supplied USB flash drive into a USB port on the computer. On most systems the flash drive should be automatically opened (mounted) by the operating system. Transfer the downloaded navigational database file to the Flash Drive. If other VoiceFlight files exist on the USB drive, erase them. Do not place the update file into any sub-directories on the flash drive. Eject the flash drive and remove it from the computer's USB port.
3. At the aircraft, plug a suitable aviation headset into the pilot's headset jacks so that audio responses from the VFS101 can be heard. Alternatively, the aircraft's cockpit speaker may be utilized.
4. With the Aircraft stationary, apply power to the aircraft audio panel and the VFS101. Wait at least thirty seconds for the VFS101 to initialize before inserting the USB flash drive into the VFS101 USB jack.
5. Wait at least one additional minute for the update to be performed. Depress and hold the VAS. An audio message indicating that the navigational update has completed should be heard through the audio system. If the audio message is not heard wait another full minute and try depressing the VAS again. If the message is still not heard, remove the USB drive, remove power from the units and repeat steps 4 & 5.
6. Remove the USB flash drive from the VFS101 USB jack.
7. Install a navigational database data-card with the matching cycle number into the primary GPS (and secondary GPS if so equipped). Apply power to the GPS(s), wait for them to initialize, and acknowledge their self-test screens as required.
8. Depress and hold the VAS. If a simple error tone or double beep is heard, without the explicit warning message "WARNING Navigation data is not current", then the VFS101 has determined that the navigational databases have matching cycle numbers.

## **7.0 Maintenance and Continued Airworthiness**

As a solid-state electronic device, no regular service actions are required. However, regular updates are required for the VFS101 navigational data. The responsible individual will ensure the VFS101 navigational database is updated to the current AIRAC charting cycle. This update must be performed using the steps listed in section 6.7 of this document. The procedure is also described in the VFS101 Pilot's Guide (VFS101-PMAN).

For further information on VFS101 continued airworthiness, see the VFS101 Instructions for Continued Airworthiness (VFS101-ICA).

## Appendix A: VFS101 Connector Pin-out

The VFS101 wiring harness uses a DB-25F Connector, AMP p/n: 5205207-1 or equivalent

See Appendix C for back-shell and other part information.

<b>Pin #</b>	<b>Function</b>
1	Pilot Microphone Signal
2	Reserved
3	Microphone Shield (Ground)
4	USB N-Data
5	USB VCC
6	Pilot's VoiceFlight Activation Switch (VAS)
7	Ground
8	Aviation Out Receive
9	Primary GPS Crossfill Receive
10	Secondary GPS Crossfill Receive
11	Secondary GPS Crossfill Shield (internal 0.1uF cap to ground)
12	Audio Output-Low
13	Aircraft Power (+14 / +28V DC)
14	Pilot Microphone Return
15	Reserved
16	USB Ground
17	USB P-Data
18	USB Shield
19	Reserved
20	Primary GPS Crossfill Shield (internal 0.1uF cap to ground)
21	Primary GPS Crossfill Transmit
22	Secondary GPS Crossfill Transmit
23	Audio Output Shield (internal 0.1uF cap to ground)
24	Audio Output (High)
25	Aircraft Ground
Connector Shell	Ground

## Appendix B: Wiring Diagram

### VFS101

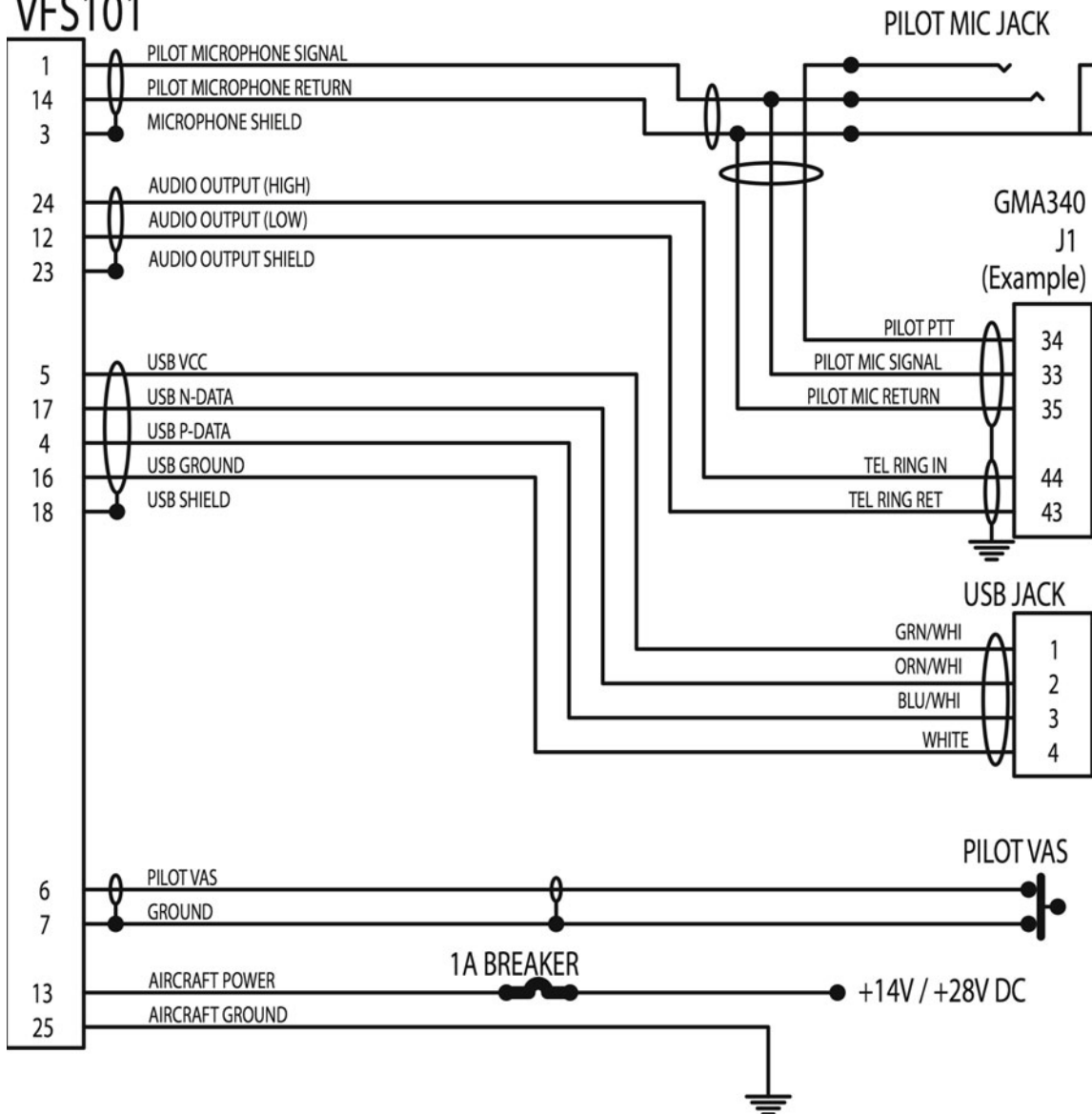

**Note:** VFS101 pin 23 (Audio Output Shield) is internally connected to Aircraft Ground by way of a .1 uF capacitor to prevent ground loops.

**Note:** When connecting the wires to the VFS101 and **audio panel** at the microphone jack, be sure not to connect the shields to avoid undesirable ground loops.

**Wire:** See next page for wire type information.

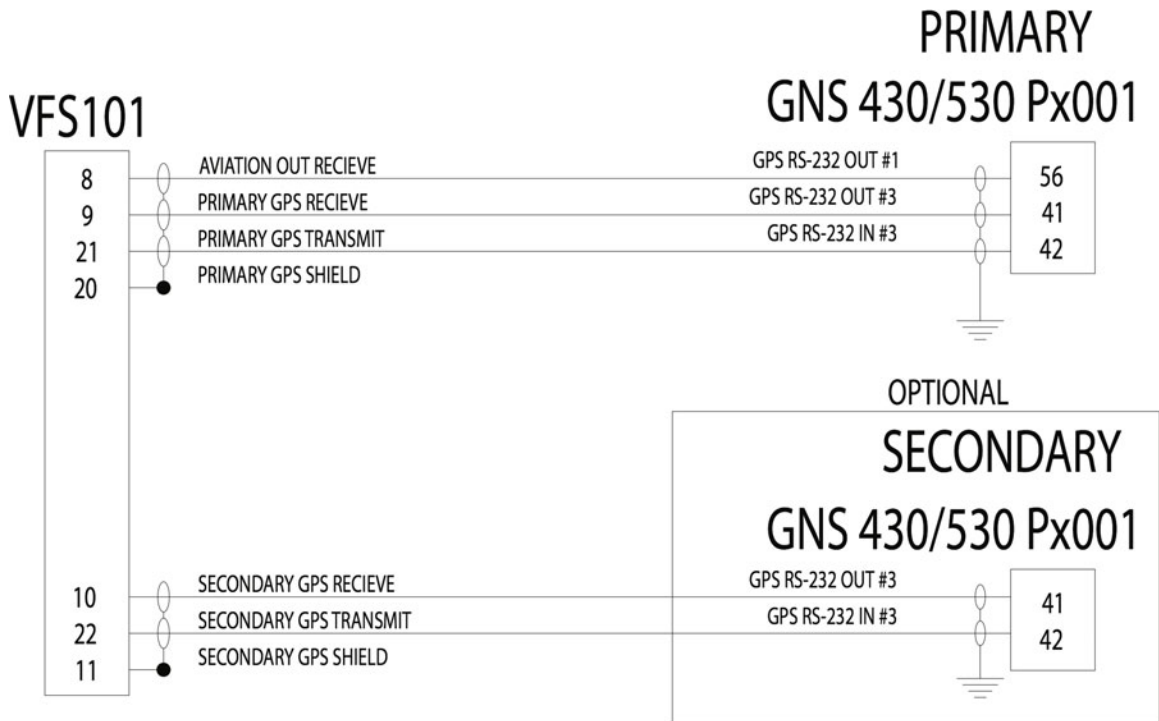

**Note:** Approved software revisions for the Garmin GNS 430/GNS 530 Units are:

- **Garmin GNS 430** – “Main Software” revision 5.03
- **Garmin GNS 530** – “Main Software” revision 6.03

**Note:** Alternative RS-232 ports on the GPS units may be used. The ports and pin numbers shown are the recommended port assignments. See section 6.3 and the Garmin GNS 430 or GNS 530 installation manual for information on selecting an alternate port.

**Note:** VFS101 pins 11 (Secondary GPS Shield) and 20 (Primary GPS Shield) are internally connected to Aircraft Ground by way of separate .1 uF capacitors to prevent ground loops.

**Wire (Power and Aircraft Ground):** MIL-C-27500 cable or equivalent wire from AC 43.13-1B table 11-11, in 20 AWG.

**Yoke Coil Cable (VAS connection.):** STEC p/n 3953 (5 conductor) or STEC p/n: 3934 (19 conductor) (or equivalent cable meeting the requirements of FAR 23.1359(c))

**Wire (All other connections):** MIL-C-27500 cable or equivalent wire from AC 43.13-1B table 11-11, in 24 AWG minimum. Shielded cable must be used as shown.

## Appendix C: Part Numbers

<b>Part Description</b>	<b>Acceptable Part Numbers and/or Part Characteristics</b>
Wire (Power and Aircraft Ground)	MIL-C-27500 cable or equivalent wire from AC 43.13-1B table 11-11, in 20 AWG.
Yoke Coil Cable (VAS connection.)	STEC p/n 3953 (5 conductor) or STEC p/n: 3934 (19 conductor) (or equivalent cable meeting the requirements of FAR 23.1359(c))
Wire (All other connections)	MIL-C-27500 cable or equivalent wire from AC 43.13-1B table 11-11, in 24 AWG minimum. Shielded cable must be used as shown.
DB-25 Connector	AMP p/n: 5205207-1 or equivalent
Crimp socket contacts (20-24 AWG)	AMP p/n: 205090-1 or equivalent
DB-25 Connector Backshell	AMP p/n: 5748676-3 or equivalent
Circuit Breaker (1 Amp)	Klixon p/n: 7274-2-1 or equivalent
VoiceFlight Activation Switch (VAS)	Any of the following switches may be used: Piper, p/n: 688-289 Cessna/Mason, p/n: S1985-1 C & K, p/n: 8633 C & K, p/n: MSPS103CO Grayhill, p/n: 23-1 Alco, p/n: MSPM-101B
Pilot's Microphone Jack	Switchcraft p/n: 11 Switchcraft p/n: 111 Or other standard ¼ inch microphone jack
Microphone Jack Insulated shoulder washer	Switchcraft p/n: S1029 or equivalent
Microphone Jack Insulated flat washer	Switchcraft p/n: S1028 or equivalent
Alternative Power Switch (used instead of the Circuit Breaker, with Fuse Holder and Fuse)	Alco p/n: MTA-106E C & K p/n: 7101SH3ZQE
Alternative Fuse Holder (used instead of the Circuit Breaker, with Power Switch and Fuse)	Littelfuse: FNY-1 Littelfuse: FHP-1
Alternative 1A Fuse (used instead of the Circuit Breaker, with Power Switch and Fuse Holder)	Littelfuse: AGC-1
Mounting Hardware	See parts list for appropriate configuration in Appendix E

## Appendix D: Mechanical Dimensions

All dimensions in inches.

### VFS101 Footprint



### USB Jack Cutout

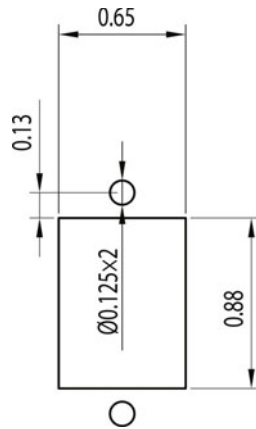

## Appendix E: Installation Options

### Tray Mount

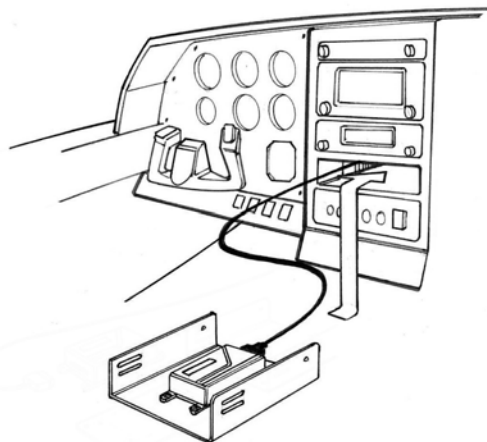

#### Part Numbers:

- 1: VFS101 (VFS101 Unit) Qty: 1
- 2: VFS101-M006-A (Mounting Tray) Qty: 1
- 3: MS51957-41 (#8 Mach. Screws, 1/4 inch) Qty: 4
- 4: MS51957-30 (#6 Mach. Screws, 1/2 inch) Qty: 6
- 5: MS35649-284 (#8 Mach. Screw Nuts) Qty: 4
- 6: MS35649-264 (#6 Mach. Screw Nuts) Qty: 2
- 7: MS35333-72 (#8 Star Lock Washers) Qty: 4
- 8: MS35333-71 (#6 Star Lock Washers) Qty: 2
- 9: Monadnock 294667 (#6 Clip-Nuts) Qty: 4

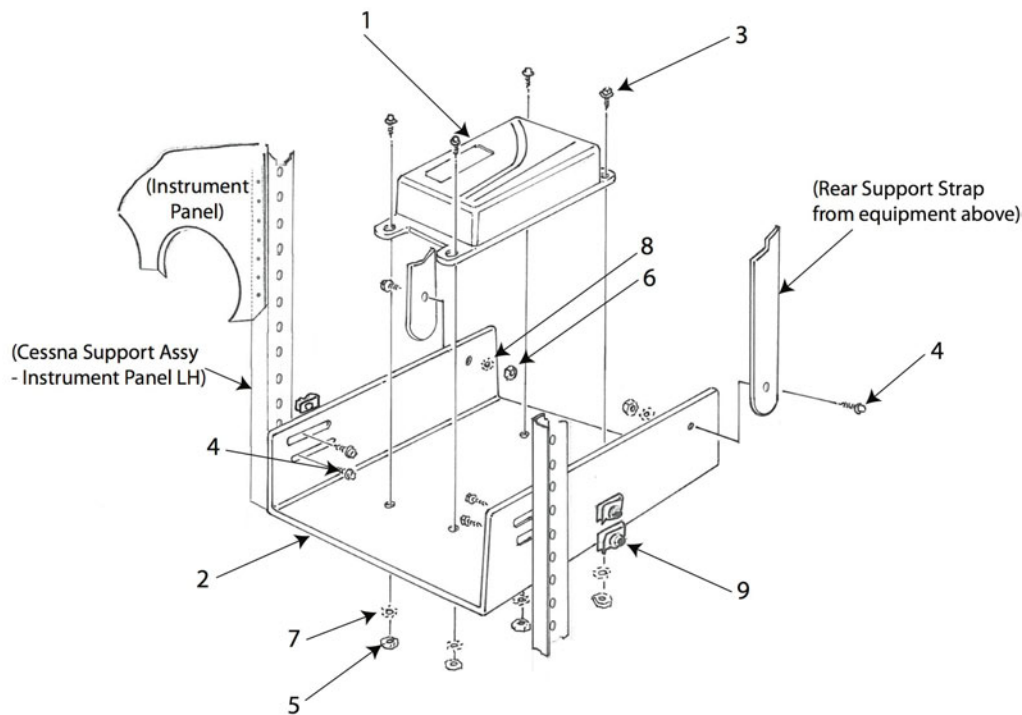

#### Notes:

Drill two 0.144 inch holes through supporting strap into Tray (VFS101-M006) to accommodate #6 rear mounting screws.

See Appendix B for Wiring Diagram.



## Panel Mount

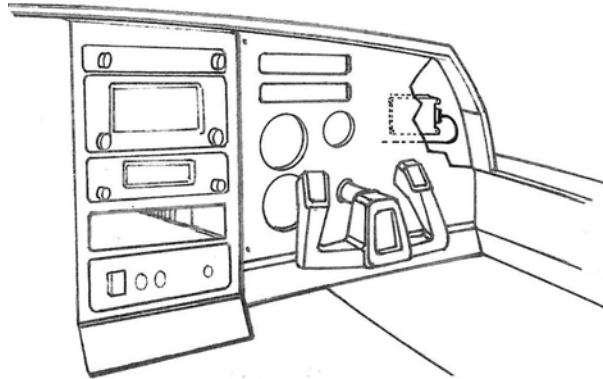

### Part Numbers:

- 1: VFS101 (VFS101 Unit) Qty: 1
- 2: MS51957-45 (#8 Machine Screw, 1/2 in). Qty: 4
- 3: MS35333-72(#8 Star Lock Washer) Qty: 4
- 4: MS35649-284 (#8 Mach. Screw Nuts) Qty: 4

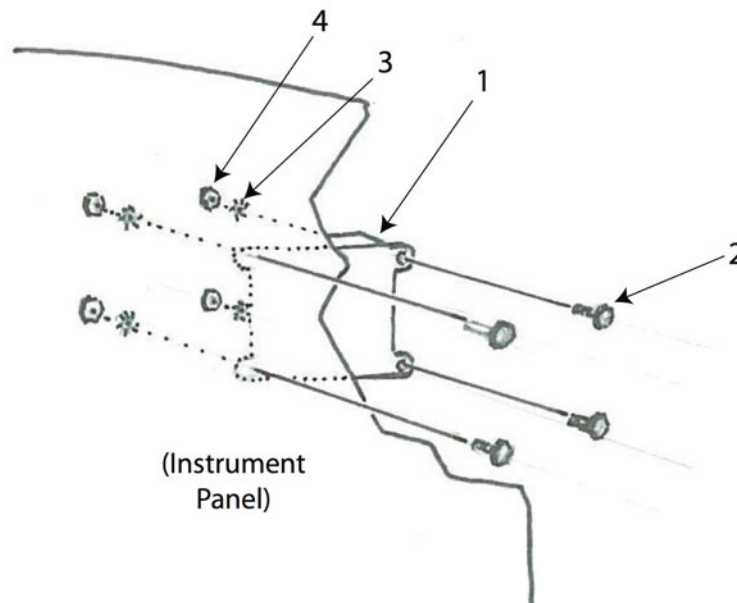

### Notes:

Install on back of unused area of instrument panel.

Minimum panel thickness: 0.024 inches. Panel Material: AL2024-T3.  
(Alternatives: AL6061-T6, AL7075-T6)

See Appendix B for Wiring Diagram.

## ***VAS Installation***

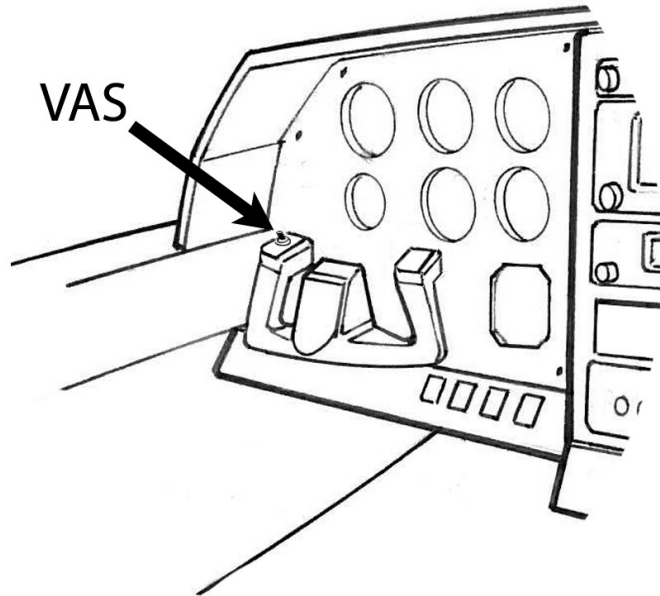

Install VAS so as not to interfere with other yoke switches

Label switch "VAS"

See Appendix B for Wiring Diagram.

# Appendix F: Tray / Sled Fabrication Drawings

## Tray Fabrication Drawing

Construct of minimum 0.024 inch thick AL2024-T3 (Alternatives: AL6061-T6, AL7075-T6)  
Unless otherwise specified  
Dimensions in inches  
Tolerances: Decimal: X= $\pm 0.10$ , XX= $\pm 0.03$ , XXX= $\pm 0.010$ , Fractional:  $\pm 1/32$

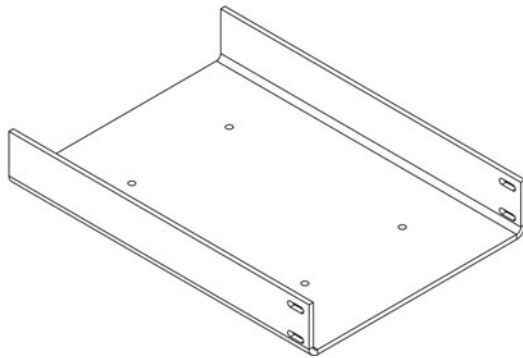
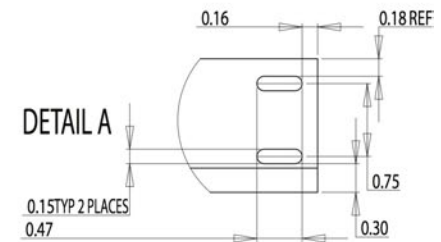
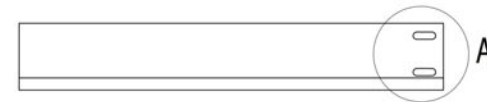
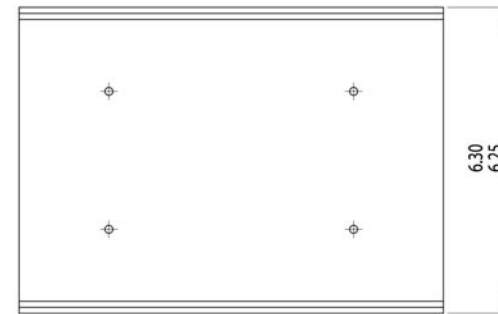
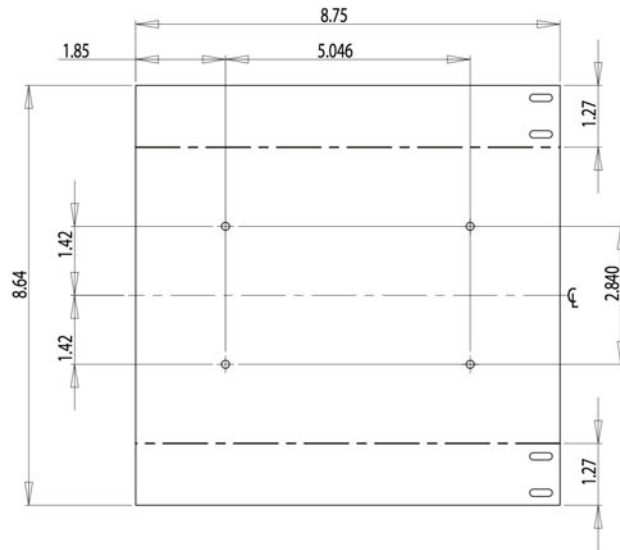

# Sled Fabrication Drawing

Construct of 0.125 inch thick AL1100-H14

Unless otherwise specified:

Dimensions in inches

Tolerances: Decimal: X= $\pm 0.10$ , XX= $\pm 0.03$ , XXX= $\pm 0.010$ , Fractional:  $\pm 1/32$

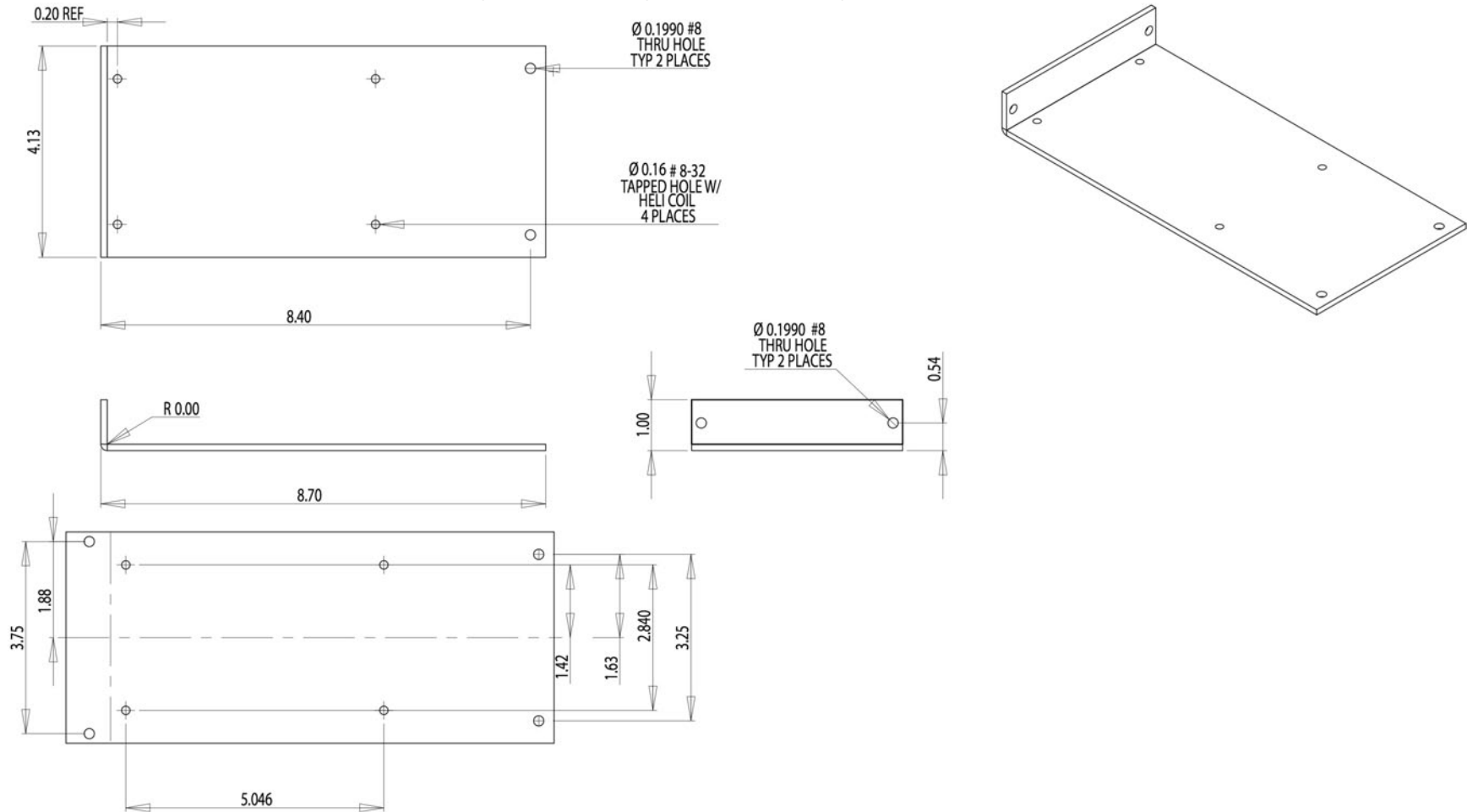

# Sled Base Fabrication Drawing

Construct of 0.085 +/- 0.005 inch thick AL1100-H14

Unless otherwise specified:

Dimensions in inches

Tolerances: Decimal: X=+/- 0.10, XX=+/- 0.03, XXX=+/- 0.010, Fractional: +/- 1/32

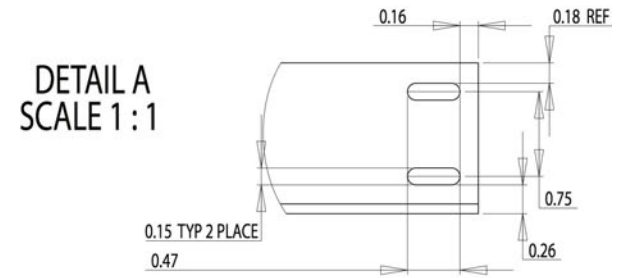
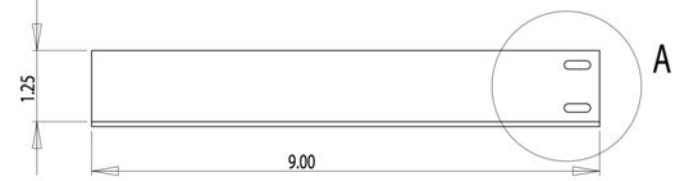
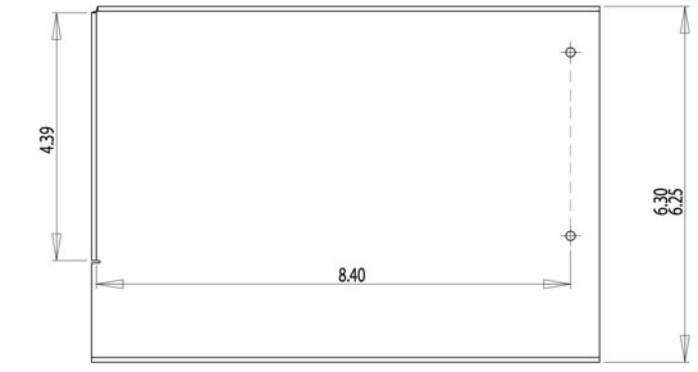
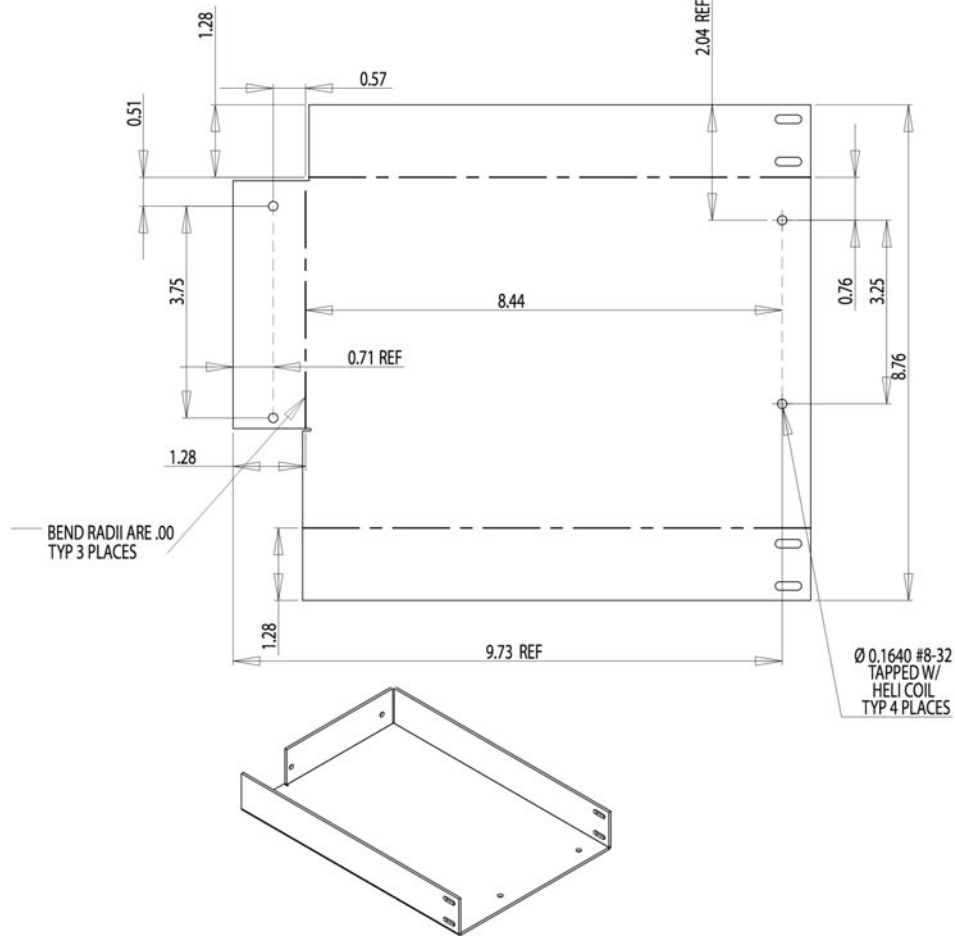

## **Appendix G: Compatible GPS Units**

**Garmin GNS 430** – “Main Software” revision 5.03

**Garmin GNS 530** – “Main Software” revision 6.03